

Origin: Mainland China

Color Categories: No Light, Red Ring Light, Red Ring Light + Power Symbol, Green Ring Light, Green Ring Light + Power Symbol, Blue Ring Light, Blue Ring Light + Power Symbol, Yellow Ring Light, Yellow Ring Light + Power Symbol, White Ring Light, White Ring Light

Description

Installation Diameter: 12mm

Mechanism Material : Base PA6 / Pin Brass Silver Plating / Base with PC

Switching Voltage: 1.5V~250V AC/DC

Contact Material: Copper Plated Silver / Silver Alloy

Switching Current: 3mA~3A

Waterproof Grade: IP66

Lamp Voltage (LED): 3VDC~220VAC (Voltage Selectable)

Protection Level: IK10

Luminous Color : Red, Yellow, Blue, Green, White, Orange (Other Colors Customizable)

Lamp Life: 40,000 Hours

Work Form: Self-locking / Self-reset (Optional)

Electrical Life: 0.2A/250VAC: 200,000 Cycles; 3A/250VAC: 50,000 Cycles

Mechanical Life: S: -30°C~+80°C

Nut Torque: 5~14N.m

Contact Resistance Value : $\leq 50\text{m}\Omega$

Button Pressure: Approximately 2.5~3N

Insulation Resistance: $\geq 1000\text{m}\Omega$

Switch Combination: (1NO) Normally Open

Compressive Strength: 1900VAC min

Connection Mode: Welded Foot (Terminal)

Key Type: Flat Surface, Convex Surface

Shell Material: H59 Copper Nickel Plating / SUS304 / Aluminum Alloy Oxidation

Product Certification: CE, ROHS

Note: Customers can choose product configurations according to requirements:

1: Standard Configuration - Copper Plated Silver Contacts

2: High Configuration - Silver Alloy Contacts

PRODUCT WIRING METHOD

Detailed Diagram

1. Preparation Before Wiring:

One green wire of the connector corresponds to Switch C (Common Pin); called Common Terminal.

One yellow wire of the connector corresponds to Switch NO (Normally Open Pin); called Normally Open Terminal.

One white wire of the connector corresponds to Switch NC (Normally Closed Pin); called Normally Closed Terminal.

One black and one red wire of the connector correspond to Switch Lamp Pins;
Lamp pins are non-polar (no distinction between positive and negative poles).



Wiring Example 1:

Do not connect the white wire (Normally Closed Terminal) of the switch;

LED light of the push button switch stays on;

Self-locking: Press to power on the device, press again to power off;

Self-reset: Press to power on the device, release to power off.

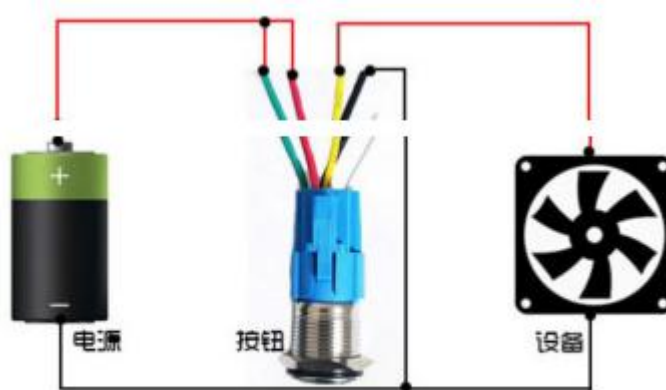

2. Wiring Example 1:

Do not connect the white wire (Normally Closed Terminal) of the switch;

LED light of the push button switch stays on;

Self-locking: Press to power on the device, press again to power off;

Self-reset: Press to power on the device, release to power off.

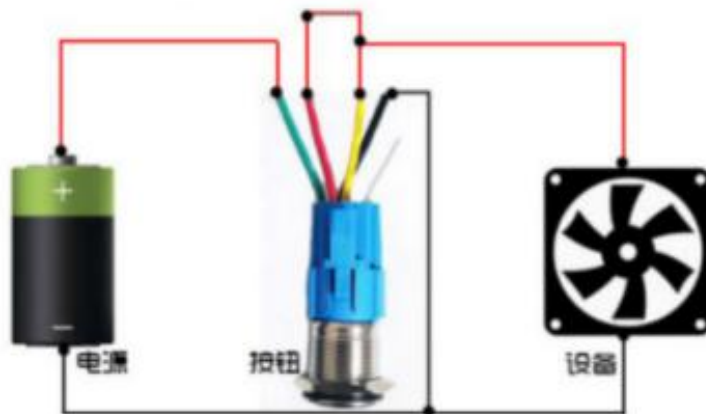

3. Wiring Example 2:

Do not connect the white wire (Normally Closed Terminal) of the switch;

LED light of the push button switch turns on when pressed, turns off when pressed again;

Self-locking: Press to power on the device, press again to power off;

Self-reset: Press to power on the device, release to power off.

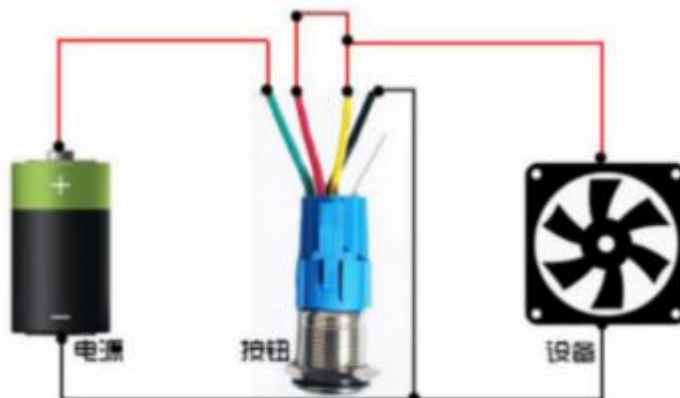

4. Wiring Example 3:

Do not connect the yellow wire (Normally Open Terminal) of the switch;

LED light of the push button switch stays on; Device is powered on when the switch is not pressed, powered off when pressed;

Self-locking: Press to power off the device, press again to power on;

Self-reset: Press to power off the device, release to power on.

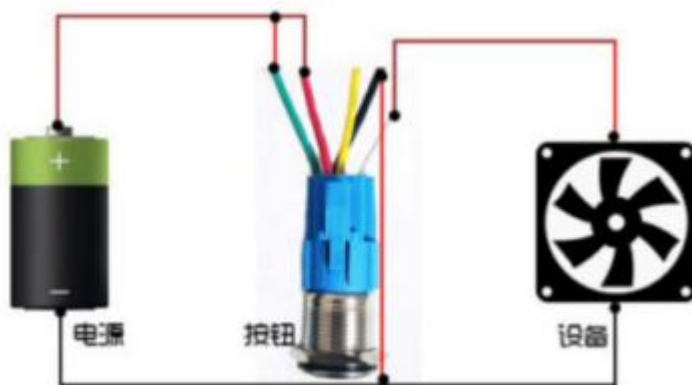

产品尺寸 详细图解

FACTORY DIRECT SALES
QUALITY ASSURANCE



12MM无灯款复位式尺寸

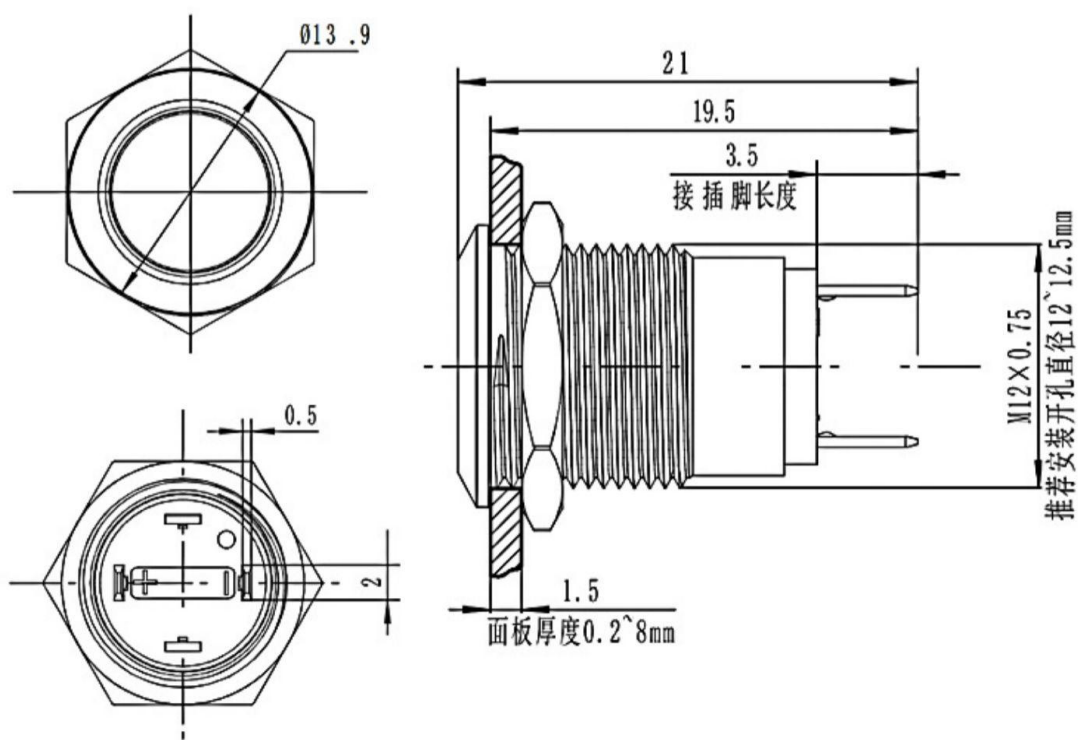

12MM尺寸

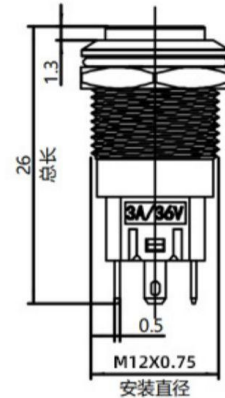
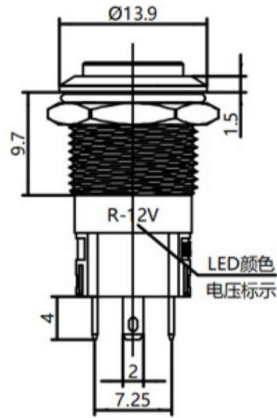
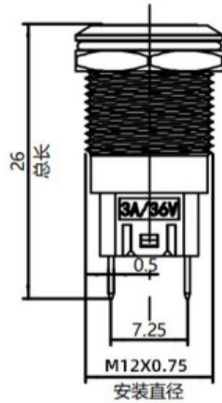
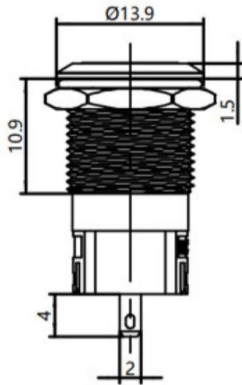
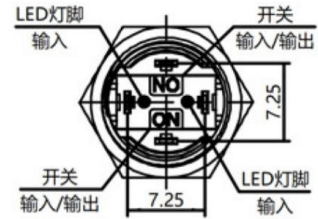
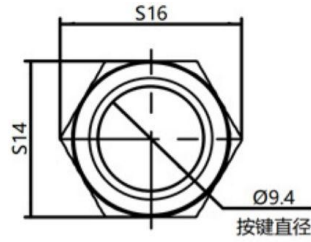
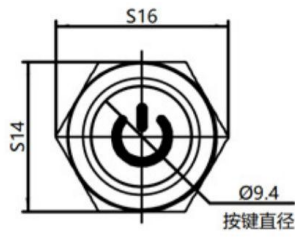

【12MM平头款】

【12MM凸头款】

开关电压	1.5V-250VAC/DC
开关电流	3mA~3A
LED电压	3V~220VAC/DC
LED电流	3mA~20mA
发光颜色	红、黄、蓝、绿、白(可定制)
工作形式	自锁式/自复式
工作环境	-20°C~+55°C
螺母扭力	5~14N.m
按键压力	约2.5~3N
开关组合	1NO(一常开)
外观材质	H59镀镍(可定制SUS304不锈钢/铝合金阳极氧化)

机构材质	底座-PA6/插针-黄铜镀银/底座附-PC
触点材质	银合金
安装尺寸	开孔12mm 空间深度30mm
防水等级	IP66
防护等级	IK10
灯珠寿命	40000小时
电气寿命	0.2A/250VAC: 20万次 3A/250VAC: 5万次
机械寿命	自锁式-25万/次 自复式-50万/次
接触电阻值	≤50mΩ
绝缘电阻	≥1000mΩ
耐压强度	1900VACmin

16MM尺寸

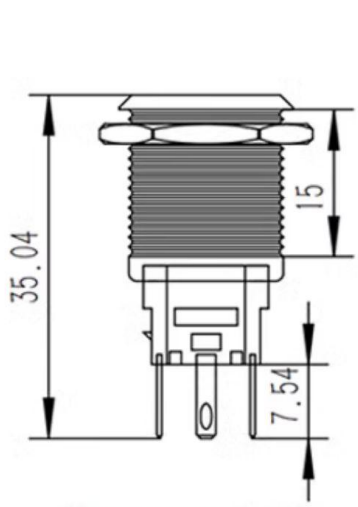
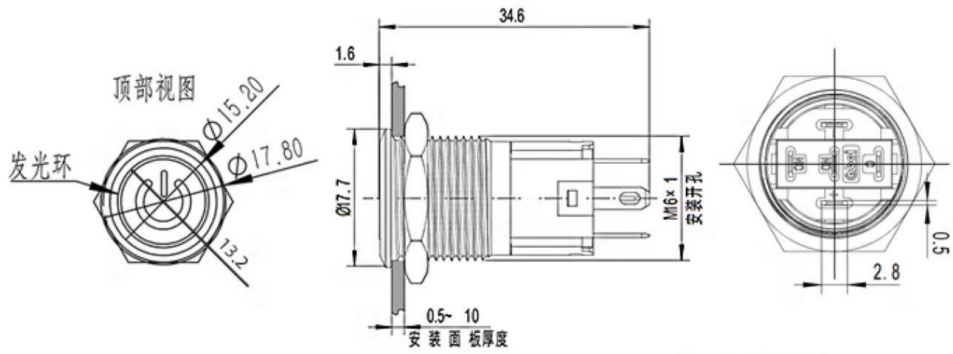

【16MM平头款】

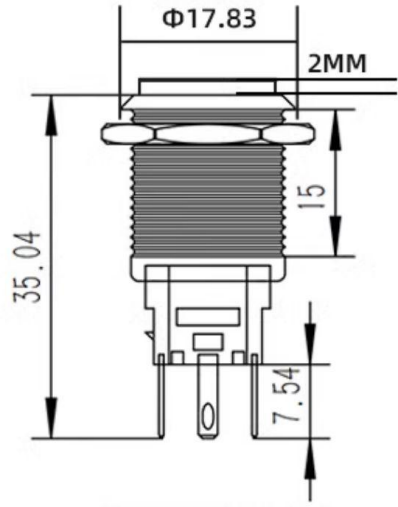

【16MM凸头款】

技术参数

1. 产品名称	(16mm) 金属按钮开关
2. 产品型号	ABS16C-P11-EC
3. 电器参数	3A/250VAC
4. 工作温度	-20°C~+55°C
5. 防水等级	IP66
6. 开关组合	1N01NC (一常开一常闭)
7. 操作类型	自复式/自锁式
8. 灯珠寿命	40000 小时
9. 灯珠电压	3V~220V
10. 外观材质	铜镀镍 (可定制SUS304不锈钢)

19MM尺寸

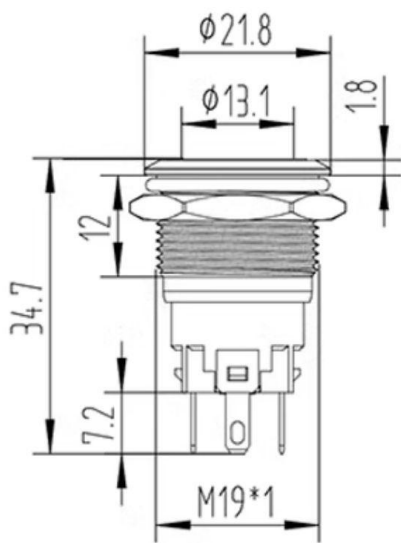
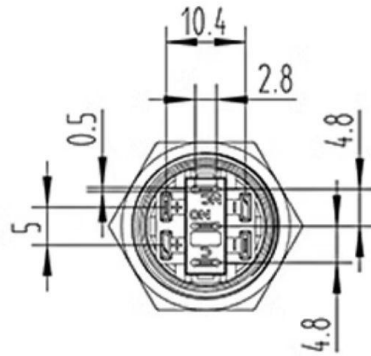
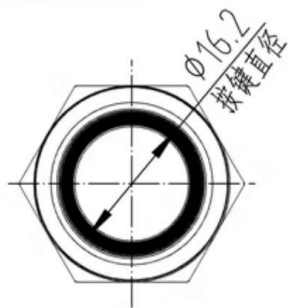

【19MM平头款】

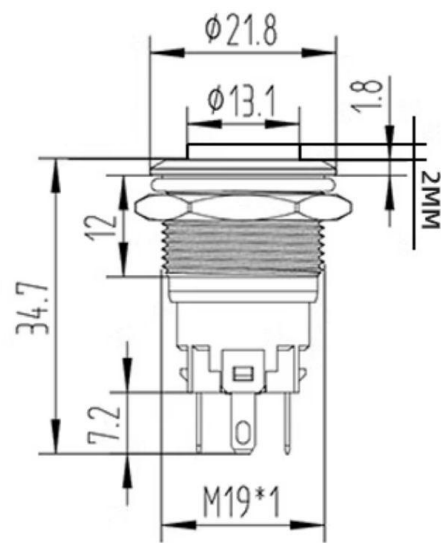

【19MM凸头款】

技术参数

1. 产品名称	(19mm) 金属按钮开关
2. 产品型号	ABS19C-P11Z-EC
3. 电器参数	3A/250VAC
4. 工作温度	-20℃~+55℃
5. 防水等级	IP66
6. 开关组合	1N01NC (一常开 一常闭)
7. 操作类型	自锁/自复位
8. 灯珠寿命	40000 小时
9. 外观材质	铜镀镍 (可定制SUS304不锈钢)

22MM尺寸

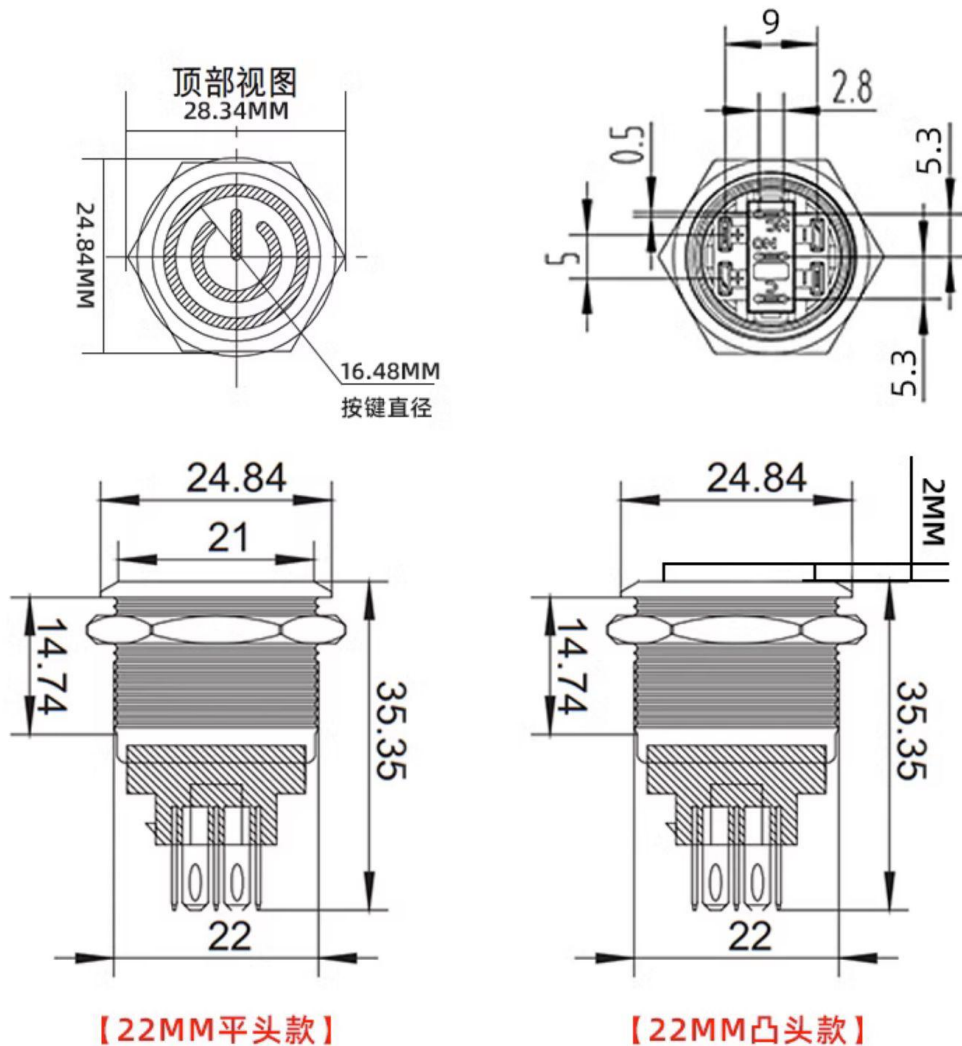

技术参数

1. 产品名称	(22mm) 金属按钮开关
2. 产品型号	XABS22C-P11-EC
3. 电器参数	5A/250VAC Max.
4. 工作温度	-20℃~+55℃
5. 防水等级	IP66
6. 开关组合	1N01NC (一常开一常闭) 2N02NC (二常开二常闭)
7. 操作类型	自复式/自锁式
8. 外壳材质	铜镀镍 (可定制SUS304不锈钢)